

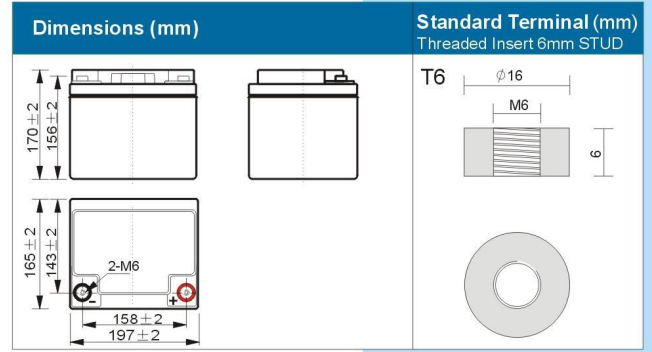

# DJM1245 (12V45AH)

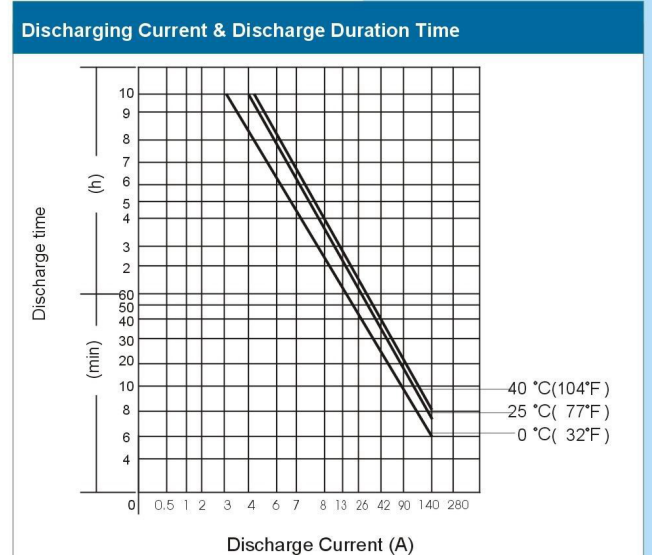

PHYSICAL SPECIFICATION		
Nominal Voltage		12V
Nominal Capacity (10HR)		42AH
Dimension	Length	197 ± 2mm (7.76 inches)
	Width	165 ± 2mm (6.50 inches)
	Container Height	170 ± 2mm (6.69 inches)
	Total Height (with Cover)	170 ± 2mm (6.69 inches)
Weight		Approx 14.5kg (32.0lbs)
Standard Terminal		Threaded Insert 6mm STUD



ELECTRICAL SPECIFICATION					
Rated Capacity	20 hour rate (2.25 A)	45.0AH	Constant-Voltage Charge	Cycle	Initial Charging Current less than 12.6A. Voltage 14.4V~15.0V at 25°C (77°F) Temp. Coefficient -30mV/°C
	10 hour rate (4.20 A)	42.0AH			
	5 hour rate (7.20 A)	36.0AH			
	3 hour rate (10.9 A)	32.7AH			
	1 hour rate (25.2 A)	25.2AH			
Capacity affected by Temperature	40°C (104°F)	103%	Standby	No limit on Initial Charging Current Voltage 13.5V~13.8V at 25°C(77°F) Temp. Coefficient -20mV/°C	
	25°C (77°F)	100%			
	0°C (32°F)	86%			

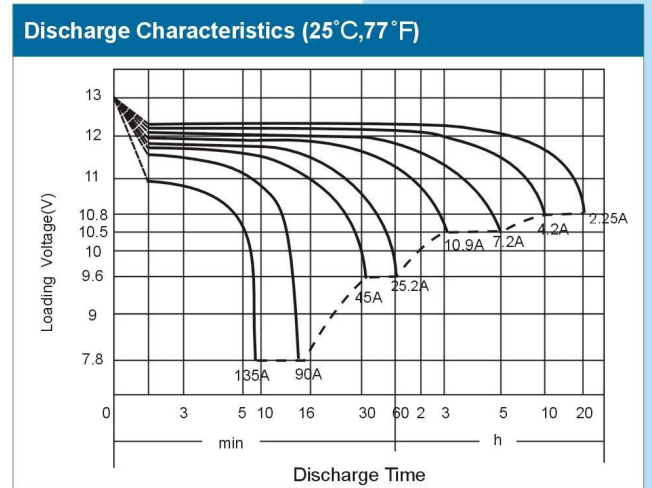

Constant Current (Amp) and Constant Power (Watt) Discharge Table (25°C, 77°F)															
Amp/Watt/Cell	Time(minute)	10	15	20	30	45	60	120	180	240	300	360	480	600	1200
	Final voltage	1.3	1.3	1.3	1.6	1.6	1.67	1.7	1.75	1.75	1.75	1.75	1.8	1.8	1.8
A		105.0	79.8	63.0	48.3	33.6	25.2	14.7	10.9	8.4	7.2	6.4	5.0	4.2	2.25
W		197.4	151.2	123.5	91.1	66.8	49.9	29.2	21.8	16.8	14.4	12.8	10.0	8.4	4.5